



SWIVEL COUPLER 10 KG

for 20 mm tube
width: 20 mm
M8 bolt; 360° rotatable

- **Art.Nr. 151 50 106 ST**
- **Art.Nr. 151 50 105 ST**



SWIVEL COUPLER 50 KG

for 35 mm tube
width: 30 mm
M10 bolt; 360° rotatable

- **Art.Nr. 151 50 102 ST**
- **Art.Nr. 151 50 102 STBK**



SWIVEL COUPLER 100 KG

for 50 mm tube
width: 30 mm
M10 bolt; 360° rotatable

- **Art.Nr. 151 50 100 ST**
- **Art.Nr. 151 50 100 STBK**



SWIVEL COUPLER 200 KG SLIMLINE

for 50 mm tube
width: 30 mm
M10 bolt

- **Art.Nr. 151 50 500 SL (360°)**
- **Art.Nr. 151 50 500 SLBK (360°)**
- **Art.Nr. 151 50 501 SL (90°, fixed)**
- **Art.Nr. 151 50 501 SLBK (90°, fixed)**



SWIVEL COUPLER 500 KG

for 50 mm tube
width: 50 mm
M12 bolt

- **Art.Nr. 151 50 500 ST (360°)**
- **Art.Nr. 151 50 500 STBK (360°)**
- **Art.Nr. 151 50 502 ST (90°, fixed)**
- **Art.Nr. 151 50 501 STBK (90°, fixed)**



SWIVEL COUPLER 750 KG

for 50 mm tube
width: 50 mm
M12 bolt

- **Art.Nr. 151 50 750 ST (360°)**
- **Art.Nr. 151 50 751 STBK (360°)**



Our couplers are TÜV tested, and have an in-house quality control.

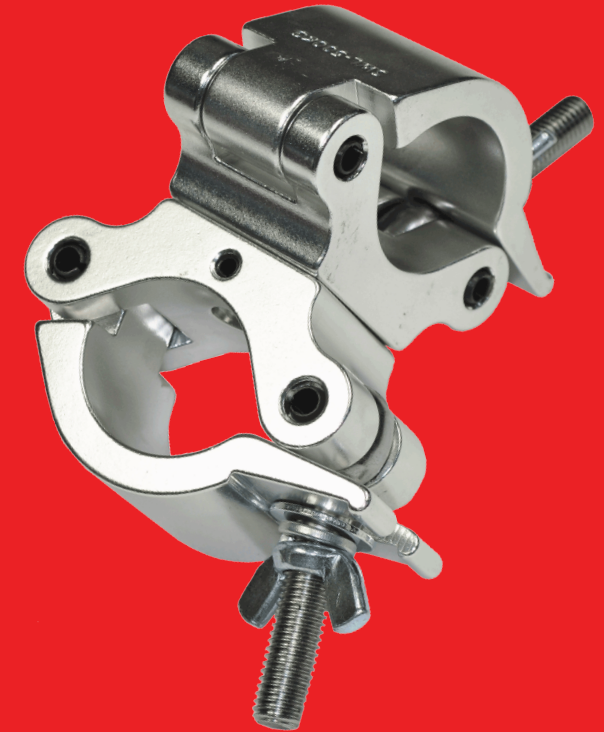

COUPLER

CJS EUROPE

c/o H.O.F. Alutec
Brookstraße 8
D-49497 Mettingen
T +49 (0) 54 52-97 33-18
sales@cjs-europe.com
www.cjs-europe.com



www.cjs-europe.com



HALF COUPLER 10 KG

for 20 mm tube
width: 20 mm
M8 bolt

- **Art.Nr. 151 35 110 11 T**
- **Art.Nr. 151 35 110 10 T**



HALF COUPLER 200 KG

for 50 mm tube
width: 50 mm
with ring bolt M10

- **Art.Nr. 151 50 500 14 TR**
- **Art.Nr. 151 50 500 14 TBK**



HALF COUPLER 750 KG

for 50 mm tube / 60 mm tube
width: 50 mm
M12 bolt

- **Art.Nr. 151 50 750 12 T (50 mm)**
- **Art.Nr. 151 50 750 12 TBK (50 mm)**
- **Art.Nr. 151 50 500 60 10 T (60 mm)**
- **Art.Nr. 151 50 500 60 10 TBK (60 mm)**



HALF COUPLER 75 KG

for 35 mm tube
width: 30 mm
M10 bolt

- **Art.Nr. 151 35 110 08 T**
- **Art.Nr. 151 35 110 08 TBK**



HALF COUPLER 200 KG

for 50 mm tube
width: 30 mm
with ring nut M10

- **Art.Nr. 151 50 500 15 TRSL**
- **Art.Nr. 151 50 500 15 TRSLBK**



SIDEENTRYCLAMP

for 50 mm tube
width: 50 mm (500 kg)
width: 30 mm (300 kg)

- **Art.Nr. 151 50 500 11 T (500 kg)**
- **Art.Nr. 151 50 300 11 T (300 kg; slim)**



HALF COUPLER 100 KG

for 50 mm tube
width: 30 mm
M10 bolt

- **Art.Nr. 151 50 100 08 T**
- **Art.Nr. 151 50 100 08 TBK**
- **Art.Nr. 151 50 100 08 TF (stainless steel)**



HALF COUPLER 200 KG

for 50 mm tube
width: 30 mm
with M10 bolt

- **Art.Nr. 151 50 200 11 T**
- **Art.Nr. 151 50 200 11 TBK**



UNI-CLAMP 15 KG

for 13-55 mm tube
incl. plate adaptor
for mini spigot M10 steel m/f

- **Art.Nr. 151 50 15 UNI**
- **Art.Nr. 151 50 5019-14BSM (spigot f)**
- **Art.Nr. 151 50 5019-14SM (spigot m)**



HALF COUPLER 100 KG

for 50 mm tube
width: 30 mm
M10
with big wing nut

- **Art.Nr. 151 50 100 11 T**
- **Art.Nr. 151 50 100 11 TBK**



HALF COUPLER 500 KG

for 50 mm tube
width: 50 mm
M10 bolt

- **Art.Nr. 151 50 500 10 T**
- **Art.Nr. 151 50 500 10 TBK**



MULTICLAMP 250 KG

for 50 mm tube
M10 bolt

- **Art.Nr. 151 50 250 10**
- **Art.Nr. 151 50 250 10 BK**



HALF COUPLER 100 KG

for 50 mm tube
width: 30 mm
M10
with quick lock

- **Art.Nr. 151 50 100 10 T**



HALF COUPLER 500 KG

for 50 mm tube
width: 50 mm
with half conical connector (male)
incl. pin and cotter pin

- **Art.Nr. 151 50 500 11 TK**



QUICK-MULTICLAMP

for 50 mm tube (250 kg)
for 35 mm tube (50 kg)
M10 bolt

- **Art.Nr. 151 50 250 10 Q (50 mm)**
- **Art.Nr. 151 50 250 10 QBK (50 mm)**
- **Art.Nr. 151 50 250 11 Q (35 mm)**
- **Art.Nr. 151 50 250 12 Q (35 mm)**